

HALIFAX COUNTY LANDFILL FACILITY INFORMATION

1.0 OVERVIEW

Halifax County currently owns and operates a landfill facility located at 921 Liles Road in Littleton. Access for the facility is and will continue to be off of Liles Road. The landfill is permitted under NC Solid Waste Permit 42-04 for the disposal of construction and demolition debris (C&D) waste and the disposal of coal combustion by-products in separate disposal areas. The County also conducts several other solid waste management activities at the facility. Refer to the attached **Figure 1**, which shows the existing conditions and **Section 2.1**, which describes facility services.

The County has operated the landfill under the current permit since 1981. From 1981 through December 1997, the landfill was permitted to receive municipal solid waste (MSW). The MSW was disposed of in one unlined disposal unit (see **Figure 1**). The MSW unit was closed in accordance with applicable State Solid Waste Management Rules.

Beginning in January 1998, and in accordance with State solid waste rules, MSW was no longer disposed of in the unlined landfill. The landfill has continued to operate since 1997 as a C&D landfill (Area 1 disposal unit). The Area 1 C&D disposal unit is a vertical expansion over the MSW disposal unit and has a waste footprint of approximately 6 acres. As Area 1 nears capacity, the County plans to develop the Area 2 disposal unit at the facility.

2.0 FACILITY SERVICES AND WASTE STREAM

2.1 Facility Services

Currently, the following activities or services are provided at the Halifax County Landfill facility:

- Scale and scale house;
- Administrative office and maintenance building;
- Area 1 C&D Landfill Unit (vertical expansion over closed unlined MSW unit);
- Area 2 C&D Landfill Unit (Proposed);
- Ash Monofill;
- Animal Waste Disposal Area;
- Wood Waste Processing Area;
- White Goods and Scrap Metal Handling Area;
- Used Tire Storage Area;
- Electronic Waste Storage Area; and
- Used Pesticide Container Storage Area.

2.2 Types of Waste

C&D waste, white goods, tires, yard waste, electronic waste (computers, televisions, etc.), and used pesticide containers are accepted at the Halifax County Landfill facility. The facility also has an ash monofill disposal unit for disposal of coal combustion waste generated by the Roanoke Valley Energy Facility (owned by Westmoreland Power, Inc.) in Weldon. The facility does not accept municipal solid waste (MSW).

Wastes are routed to the appropriate disposal unit or handling area. Stored recyclable materials (white goods, scrap metal, used tires, electronic waste, etc.) are periodically collected and transported to recycling facilities.

2.3 Disposal Rates and Anticipated Variances

An average of between 4,000 to 8,000 tons per year of C&D waste is currently accepted at the Halifax County facility, which is currently disposed of within the existing Area 1 landfill unit. As currently permitted, the County may dispose of a maximum of 20,000 tons per year of C&D waste. The amount of waste disposed in the ash monofill has varied greatly but is currently approximately 160,000 tons per year. Actual annual amounts of both C&D waste and coal combustion by-products are expected to vary considerably.

2.4 Service Area

The landfill facility serves Halifax County.

3.0 FACILITY OPERATING HOURS

Normal hours of operation are 8:00 A.M. to 4:00 P.M. Monday through Friday. The facility is normally closed on weekends and holidays. The County may elect to modify these hours from time to time. Authorized personnel are allowed to access the ash monofill for disposal of coal combustion waste beyond normal operating hours per the County's agreement with Westmoreland Power, Inc.

4.0 LANDFILL CAPACITY

4.1 C&D Landfill

The existing Area 1 and future Area 2 C&D landfill units currently have a combined life expectancy of approximately 15 years assuming an average disposal rate of 7,500 tons/year.

4.2 Ash Monofill

The existing (Cells 1 and 2) and future (Cells 3 and 4) cells of the ash monofill currently have a combined life expectancy of approximately 15 years assuming an average disposal rate of 160,000 tons/year.

5.0 EXISTING TRAFFIC

Based on recent information logged at the site, the facility currently receives approximately 16,300 vehicles per year which require weighing in at the scale house. Assuming 260 operations days per year, this equates to an average of approximately 63 in-coming vehicles per day.

G:\CAD\Halifax\Halifax 10-4\sheets\HALI-B0157.dwg - 7/6/2011 3:30 PM

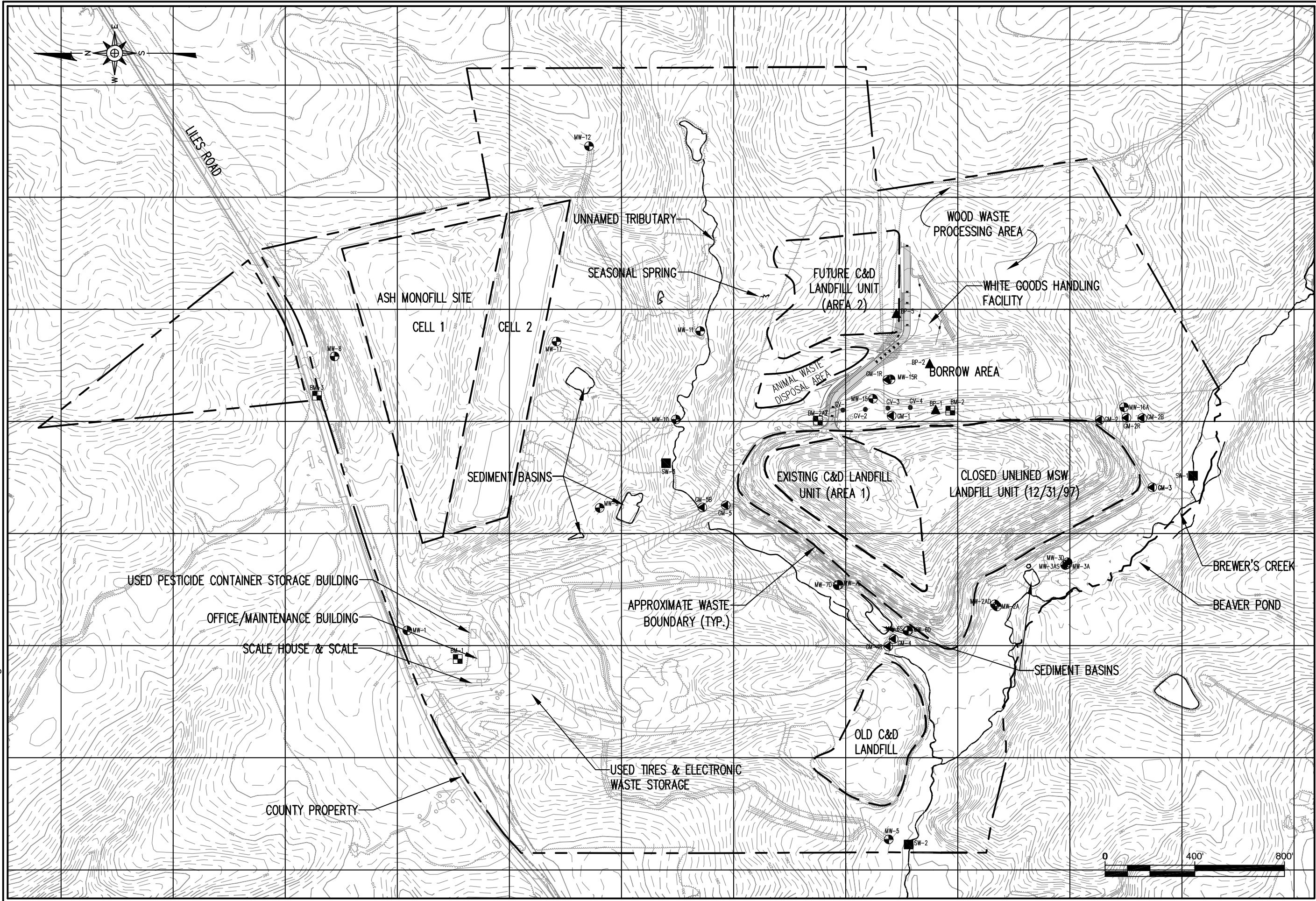

RICHARDSON SMITH GARDNER & ASSOCIATES
INC. LIC. NO. C-2282 (Engineering)
 www.rsgengineers.com
 14 N. Boylan Ave.
 Raleigh, N.C. 27603
 ph: 919-826-0577
 fax: 919-826-3898

FIGURE NO.	1
SCALE:	AS SHOWN
CHECKED BY:	P.K.S.
DRAWN BY:	C.T.J.
PROJECT NO.	HALIFAX 10-4
DATE:	Jul. 2011
FILE NAME	HALI-B0157

TITLE:

**HALIFAX COUNTY
 LANDFILL FACILITY
 EXISTING CONDITIONS**